

WINTERBERRY DRIVE

80' R-O-W

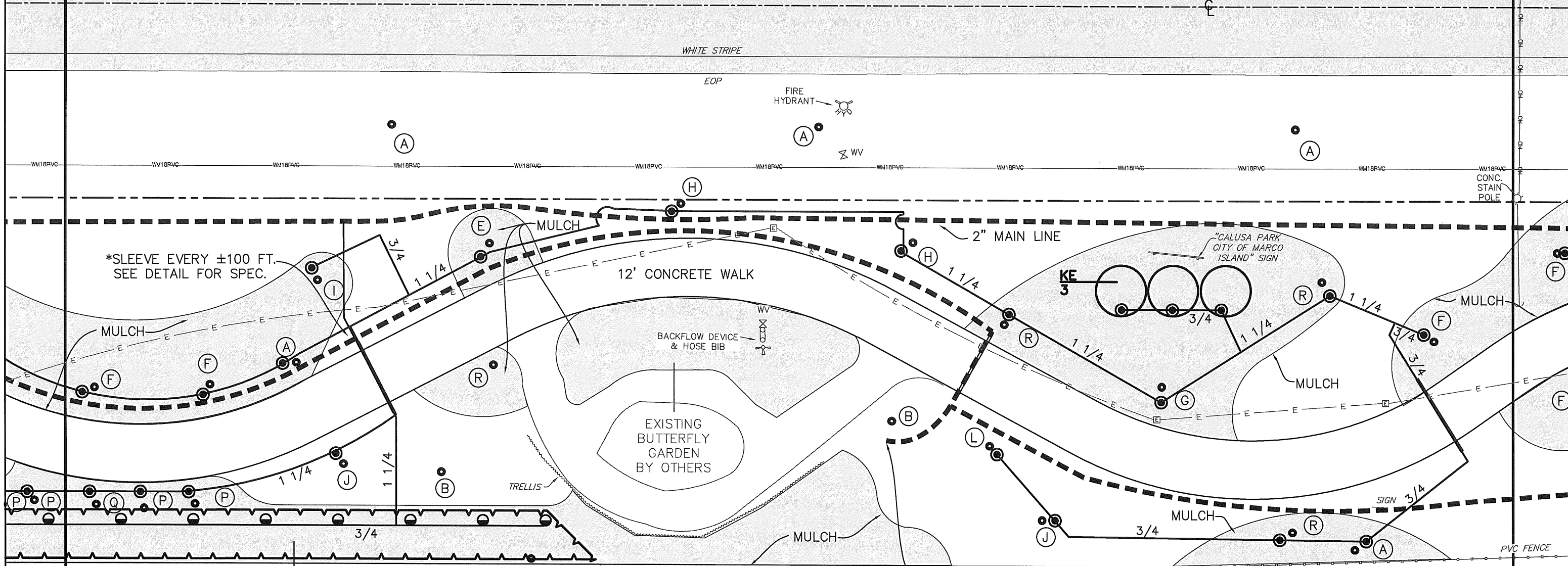

MATCHLINE
SHEET 28

Wayne Hook
2/10/17

SA
35

#1424
LOT 4, BLOCK 311
(VACANT)

LEGEND

- 2" MAIN LINE
- 570 MIST HEAD
6" 180°
- STREAM BUBBLER

#1432
LOT 5, BLOCK 311
(IMPROVED)

NEW TREES
3 KE Koelreuteria elegans Golden Rain Tree

NEW HEDGE
35 SA Dwarf Arbutus

STUB-OUT VALVE FOR
BUTTERFLY GARDEN,
CONNECTION AND HEAD
PLACEMENT BY OTHERS

EXISTING TREES

- A BLACK OLIVE = 5
- B FOXTAIL PALM = 4
- F PAUROTIS PALM = 8
- G ELLOW ELDER = 1
- H SILVER BUTTONWOOD = 3
- I TABEUBIA = 1
- P FUCYS BEBHANUBA = 2
- R COCONUT PALM = 3

#1440
LOT 6, BLOCK 311
(IMPROVED)

W. WAYNE HOOK
LICENSE NUMBER: LA0001593
1284 LASTRADA LANE
NAPLES, FLORIDA 34103-8943

MATCHLINE
SHEET 30

REVISIONS			DATE	BY	DESCRIPTION

DRAWN BY	KAS
DESIGNED BY	MDP
SCALE	1" = 20'
DATE	2016
JOB NO.	10067-089-04
REFERENCE	PLAN

**AMERICAN ENGINEERING CONSULTANTS
OF MARCO ISLAND, INC.**

CERTIFICATE OF AUTHORIZATION NUMBER: 26446
573 BALD EAGLE DRIVE MARCO ISLAND, FL 34145
(239) 394-1697 (FAX) 394-7571



CITY OF MARCO ISLAND
**WINTERBERRY DRIVE FROM
PEACOCK TERRACE TO WEST SIDE
OF BARFIELD DRIVE**

LANDSCAPING IRRIGATION CONCEPT PLAN SHEET		SHEET NO. 30
--	--	------------------------

WINTERBERRY DRIVE

80' R-O-W

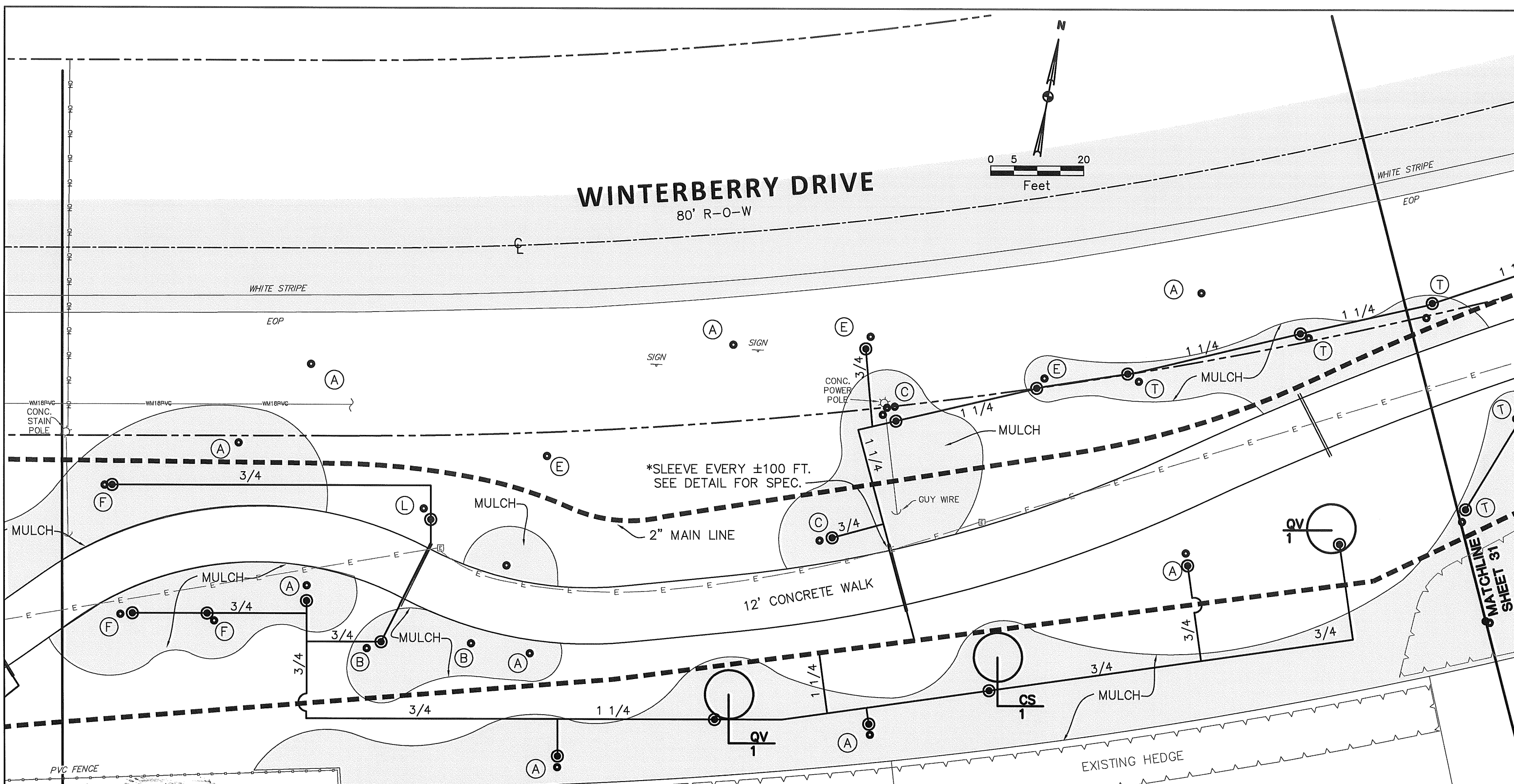

MATCHLINE
SHEET 29

Wayne Hook
#1440
LOT 6, BLOCK 311
(IMPROVED)
2/10/17

LEGEND

- 2" MAIN LINE
- 570 MIST HEAD
6" 180°
- ⊙ STREAM BUBBLER

EXISTING HEDGE

#1448
LOT 7, BLOCK 311
(IMPROVED)

#1456
LOT 8, BLOCK 311
(IMPROVED)

NEW TREES

- 1 CS Chorisia speciosa Floss Silk Tree, Pink
- 2 QV Quercus virginiana Live Oak

EXISTING TREES

- A BLACK OLIVE = 7
- B FOXTAIL PALM = 3
- C SABAL PALM = 2
- E OAK = 3
- F PAUROTIS PALM = 3
- L GUMBO LIMBO = 1
- T HONG KONG = 4

W. WAYNE HOOK
LICENSE NUMBER: LA0001593
1284 LASTRADA LANE
NAPLES, FLORIDA 34103-8943

MATCHLINE
SHEET 31

REVISIONS			DRAWN BY	KAS
DATE	BY	DESCRIPTION	DESIGNED BY	MDP
			SCALE	1" = 20'
			DATE	2016
			JOB NO.	10067-089-04
			REFERENCE	PLAN

**AMERICAN ENGINEERING CONSULTANTS
OF MARCO ISLAND, INC.**
CERTIFICATE OF AUTHORIZATION NUMBER: 26446
573 BALD EAGLE DRIVE MARCO ISLAND, FL 34145
(239) 394-1697 (FAX) 394-7571



CITY OF MARCO ISLAND
WINTERBERRY DRIVE FROM
PEACOCK TERRACE TO WEST SIDE
OF BARFIELD DRIVE

LANDSCAPING
IRRIGATION CONCEPT
PLAN SHEET

SHEET
NO.
31

WINTERBERRY DRIVE

80' R-O-W



BARCELONA COURT

60' R-O-W

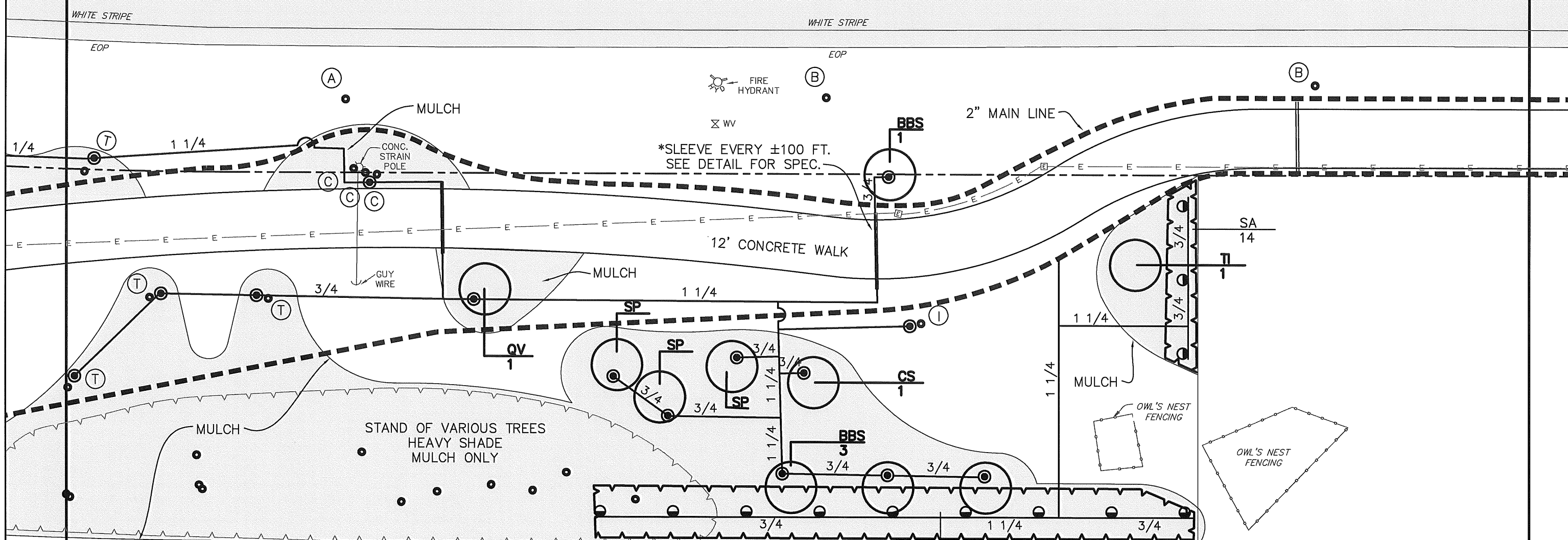

MATCHLINE
SHEET 30

MATCHLINE
SHEET 32

LEGEND

- 2" MAIN LINE
- 570 MIST HEAD 6" 180°
- STREAM BUBBLER

NEW HEDGE
40 SA Dwarf Arbaricola

NEW TREES

4 BBS	Bucida buceras	Black Olive "Shady Lady"
1 CS	Chorisia speciosa	Floss Silk Tree, Pink
2 SP	Sabal Palmetto	Cabbage Palm
1 SP1	Sabal Palmetto	Cabbage Palm
1 QV	Quercus virginiana	Live Oak
1 TI	Tabebuia impetiginosa	Tabebuia, Purple

EXISTING TREES

A	BLACK OLIVE = 2
B	FOXTAIL PALM = 2
C	SABAL PALM = 3
I	TABEBUIA = 1
T	HONG KONG ORCHID = 3

W. WAYNE HOOK
LICENSE NUMBER: LA0001593
1284 LASTRADA LANE
NAPLES, FLORIDA 34103-8943

REVISIONS			DRAWN BY	
DATE	BY	DESCRIPTION	KAS	MDP

**AMERICAN ENGINEERING CONSULTANTS
OF MARCO ISLAND, INC.**
CERTIFICATE OF AUTHORIZATION NUMBER: 26446
573 BALD EAGLE DRIVE MARCO ISLAND, FL 34145
(239) 394-1697 (FAX) 394-7571



CITY OF MARCO ISLAND
**WINTERBERRY DRIVE FROM
PEACOCK TERRACE TO WEST SIDE
OF BARFIELD DRIVE**

**LANDSCAPING
IRRIGATION CONCEPT
PLAN SHEET**

SHEET NO.
32

WINTERBERRY DRIVE

80' R-O-W

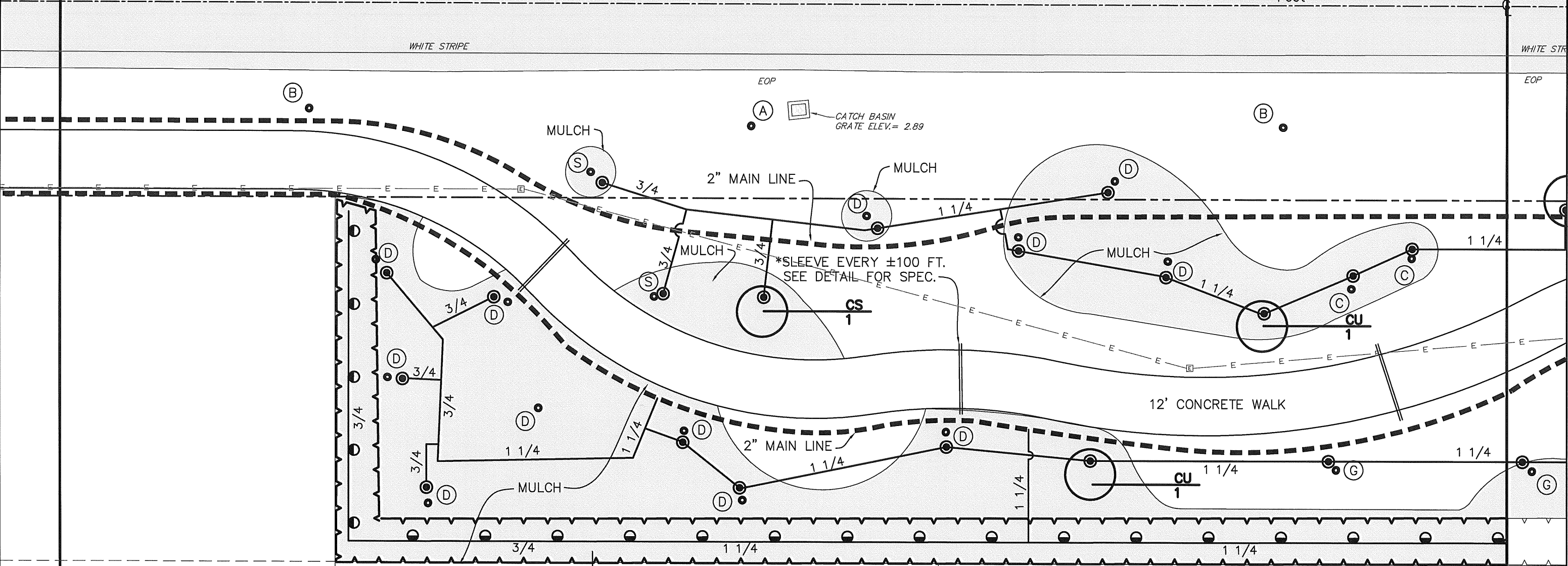
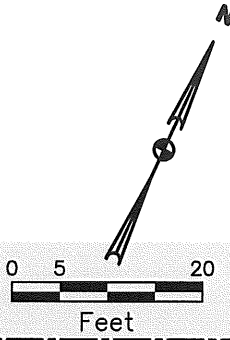

MATCHLINE
SHEET 31

MATCHLINE
SHEET 33

#1480
LOT 11, BLOCK 311
(VACANT)
Wayne Hook
2/10/17

- LEGEND**
- 2" MAIN LINE
 - 570 MIST HEAD 6" 180°
 - STREAM BUBBLER

#1488
LOT 12, BLOCK 311
(IMPROVED)

#1496
LOT 13, BLOCK 311
(IMPROVED)

- NEW TREES**
- | | | |
|------|-------------------|-----------------------|
| 1 CS | Chorisia speciosa | Floss Silk Tree, Pink |
| 2 CU | Coccoloba ubifera | Sea Grape |
- NEW HEDGE**
- | | |
|--------|-------------------|
| 102 CG | Small Leaf Clusia |
|--------|-------------------|

- EXISTING TREES**
- | | |
|---|----------------------------|
| A | BLACK OLIVE = 3 |
| B | FOXTAIL = 3 |
| C | SABAL PALM = 2 |
| D | CAPE MYRTLE = 11 |
| G | YELLOW ELDER = 2 |
| S | MANILKARA ROXBURGHIANA = 2 |

W. WAYNE HOOK
LICENSE NUMBER: LA0001593
1284 LASTRADA LANE
NAPLES, FLORIDA 34103-8943

REVISIONS			DATE	BY	DESCRIPTION

DRAWN BY	KAS
DESIGNED BY	MDP
SCALE	1" = 20'
DATE	2016
JOB NO.	10067-089-04
REFERENCE	PLAN

**AMERICAN ENGINEERING CONSULTANTS
OF MARCO ISLAND, INC.**
CERTIFICATE OF AUTHORIZATION NUMBER: 26446
573 BALD EAGLE DRIVE MARCO ISLAND, FL 34145
(239) 394-1697 (FAX) 394-7571



CITY OF MARCO ISLAND
**WINTERBERRY DRIVE FROM
PEACOCK TERRACE TO WEST SIDE
OF BARFIELD DRIVE**

**LANDSCAPING
IRRIGATION CONCEPT
PLAN SHEET**

SHEET NO.
33

PHEASANT COURT

60' R-O-W

WINTERBERRY DRIVE

80' R-O-W

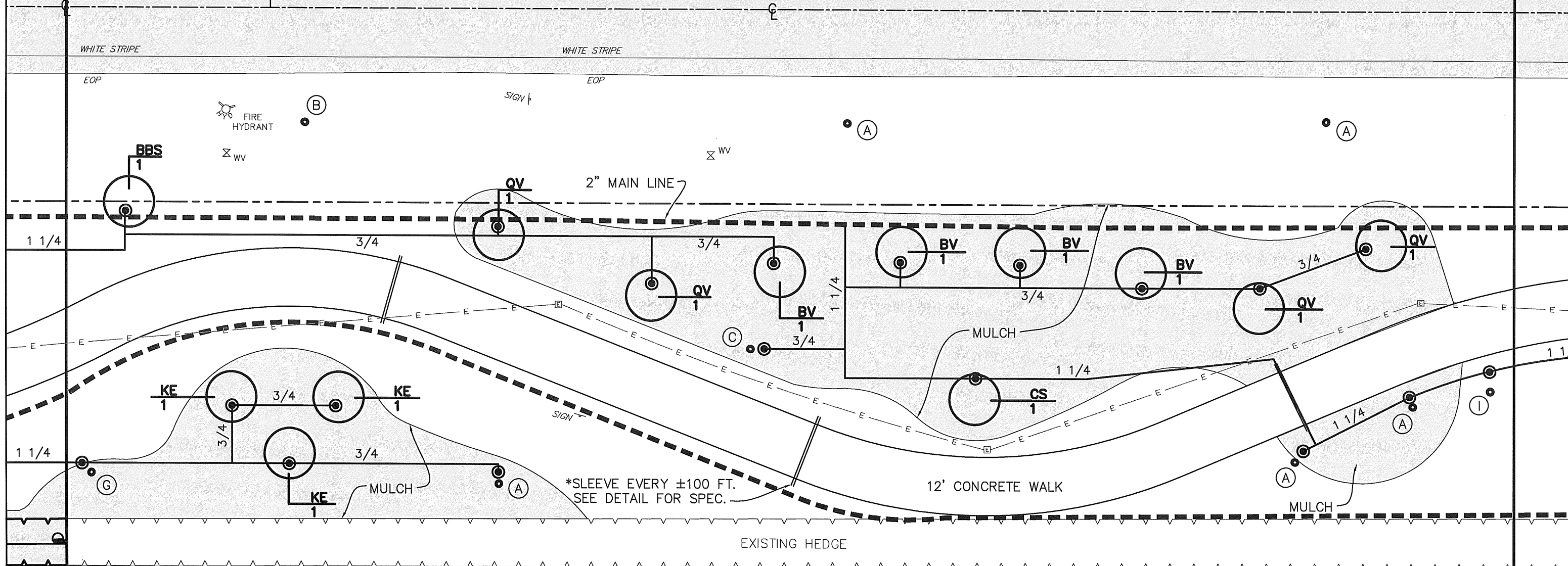
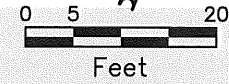

MATCHLINE
SHEET 32

W. Wayne Hook
2/10/17

LEGEND

- 2" MAIN LINE
- 570 MIST HEAD 6" 180°
- STREAM BUBBLER

#1504
LOT 14, BLOCK 311
(IMPROVED)

#1512
LOT 15, BLOCK 311
(IMPROVED)

NEW TREES

- | | | |
|-------|----------------------|--------------------------|
| 1 BBS | Bucida buceras | Black Olive "Shady Lady" |
| 4 BV | Bauhinia variegata | Hong Kong Orchid, White |
| 3 KE | Koelreuberia elegans | Golden Rain Tree |
| 3 QV | Quercus virginiana | Live Oak |

EXISTING TREES

- | | |
|---|------------------|
| A | BLACK OLIVE = 6 |
| B | FOXTAIL PALM = 2 |
| C | SABAL PALM = 1 |
| I | TABEBUIA = 1 |

W. WAYNE HOOK
LICENSE NUMBER: LA0001593
1284 LASTRADA LANE
NAPLES, FLORIDA 34103-8943

MATCHLINE
SHEET 34

REVISIONS			DRAWN BY	
DATE	BY	DESCRIPTION	KAS	MDP

AMERICAN ENGINEERING CONSULTANTS
OF MARCO ISLAND, INC.
CERTIFICATE OF AUTHORIZATION NUMBER: 26446
573 BALD EAGLE DRIVE MARCO ISLAND, FL 34145
(239) 394-1697 (FAX) 394-7571



CITY OF MARCO ISLAND
WINTERBERRY DRIVE FROM
PEACOCK TERRACE TO WEST SIDE
OF BARFIELD DRIVE

LANDSCAPING
IRRIGATION CONCEPT
PLAN SHEET

SHEET NO.
34

PERSIAN COURT

60' R-O-W

WINTERBERRY DRIVE

80' R-O-W

SANITARY MANHOLE
RIM ELEV. = 4.13



WHITE STRIPE

WHITE STRIPE

EOP

EOP

OWL'S NEST
FENCING

FIRE
HYDRANT

WV

MULCH

2" MAIN LINE

*SLEEVE EVERY ±100 FT.
SEE DETAIL FOR SPEC.

12' CONCRETE WALK

2" MAIN LINE

EXISTING HEDGE

MATCHLINE
SHEET 33

#1520
LOT 16, BLOCK 311
(IMPROVED)

LEGEND

- 2" MAIN LINE
- 570 MIST HEAD
6" 180°
- STREAM BUBBLER

CG
72

#1528
LOT 17, BLOCK 311
(IMPROVED)

NEW TREES

- 5 BBS Bucida buceras Black Olive "Shady Lady"
- 3 CS Chorisia speciosa Floss Silk Tree, Pink
- 2 DR Delonix regia Royal Poinciana, Orange
- 1 TI Tabebuia impetiginosa Tabebuia, Purple

NEW HEDGE

- 72 CG Clusia guttfera

#1536
LOT 18, BLOCK 311
(IMPROVED)

EXISTING TREES

- A BLACK OLIVE = 2
- B FOXTAIL PALM = 3

W. WAYNE HOOK
LICENSE NUMBER: LA0001593
1284 LASTRADA LANE
NAPLES, FLORIDA 34103-8943

MATCHLINE
SHEET 35

REVISIONS			DATE	BY	DESCRIPTION

DRAWN BY	KAS
DESIGNED BY	MDP
SCALE	1" = 20'
DATE	2016
JOB NO.	10067-089-04
REFERENCE	PLAN

AMERICAN ENGINEERING CONSULTANTS
OF MARCO ISLAND, INC.
CERTIFICATE OF AUTHORIZATION NUMBER: 26446
573 BALD EAGLE DRIVE MARCO ISLAND, FL 34145
(239) 394-1697 (FAX) 394-7571



CITY OF MARCO ISLAND
WINTERBERRY DRIVE FROM
PEACOCK TERRACE TO WEST SIDE
OF BARFIELD DRIVE

LANDSCAPING
IRRIGATION CONCEPT
PLAN SHEET

SHEET
NO.
35

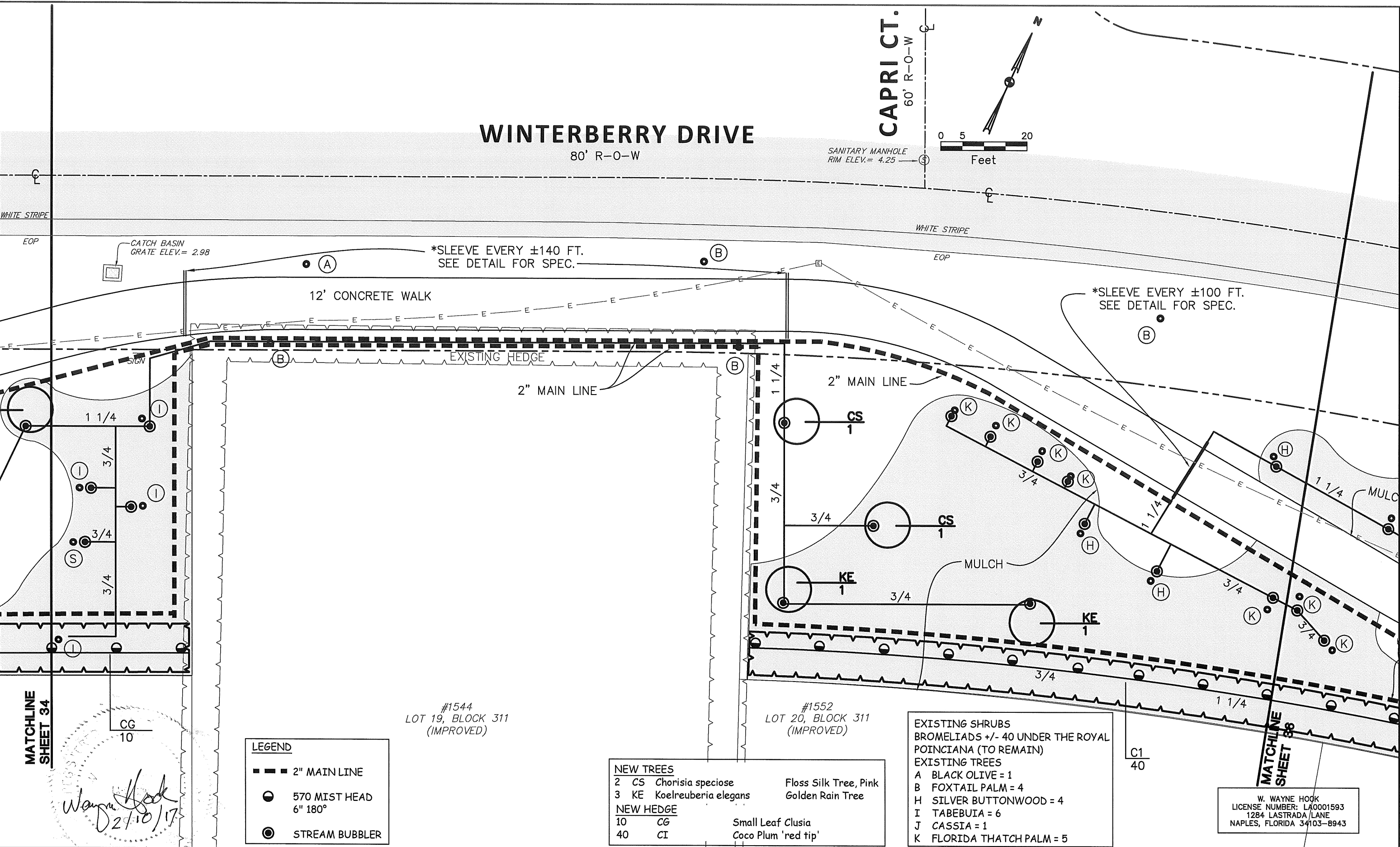

REVISIONS			DRAWN BY		KAS		AMERICAN ENGINEERING CONSULTANTS OF MARCO ISLAND, INC.	CITY OF MARCO ISLAND WINTERBERRY DRIVE FROM PEACOCK TERRACE TO WEST SIDE OF BARFIELD DRIVE	LANDSCAPING IRRIGATION CONCEPT PLAN SHEET		SHEET NO. 36
DATE	BY	DESCRIPTION	DESIGNED BY	MDP	SCALE	1" = 20'					
			DATE	2016			CERTIFICATE OF AUTHORIZATION NUMBER: 26446 573 BALD EAGLE DRIVE MARCO ISLAND, FL 34145 (239) 394-1697 (FAX) 394-7571				
			JOB NO.	10067-089-04							
			REFERENCE	PLAN							

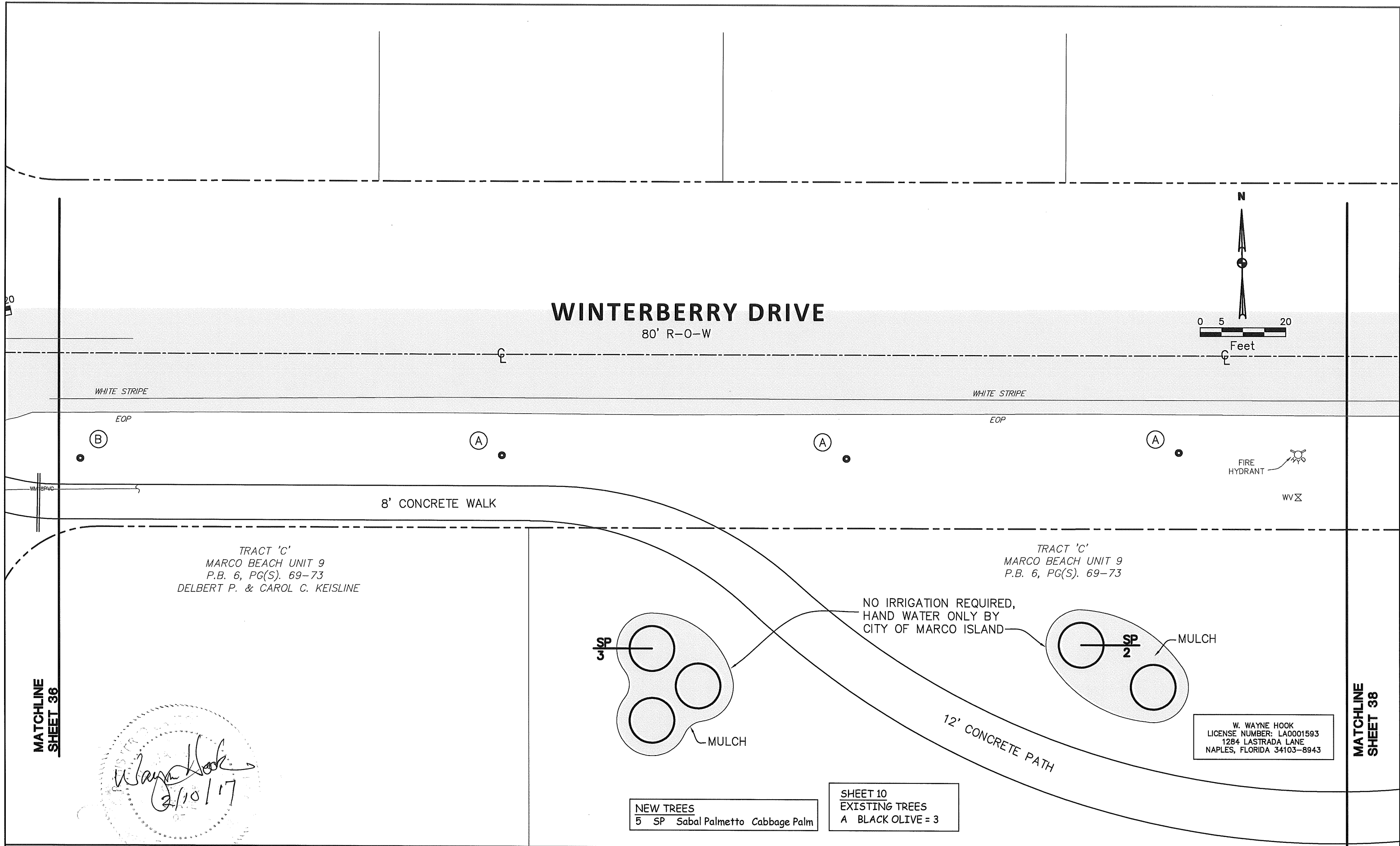

REVISIONS			DATE	BY	DESCRIPTION

DRAWN BY	KAS
DESIGNED BY	MDP
SCALE	1" = 20'
DATE	2016
JOB NO.	10067-089-04
REFERENCE	PLAN

**AMERICAN ENGINEERING CONSULTANTS
OF MARCO ISLAND, INC.**
CERTIFICATE OF AUTHORIZATION NUMBER: 26446
573 BALD EAGLE DRIVE MARCO ISLAND, FL 34145
(239) 394-1697 (FAX) 394-7571



CITY OF MARCO ISLAND
WINTERBERRY DRIVE FROM
PEACOCK TERRACE TO WEST SIDE
OF BARFIELD DRIVE

LANDSCAPING
IRRIGATION CONCEPT
PLAN SHEET

SHEET NO.
38

W. Wayne Hook
2/10/17

WINTERBERRY DRIVE

80' R-O-W

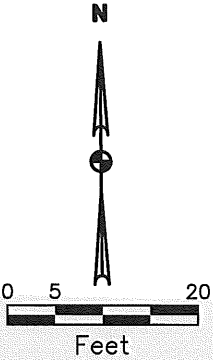

WHITE STRIPE

WHITE STRIPE

EOP

EOP

BIKE LANE
ENDS SIGN

BBS
1

BBS
1

8' CONCRETE WALK

TRACT 'C'
MARCO BEACH UNIT 9
P.B. 6, PG(S). 69-73

1819 MENORCA COURT LLC
O.R. BOOK 4766, PG. 2303

NO IRRIGATION REQUIRED,
HAND WATER ONLY BY
CITY OF MARCO ISLAND

12' CONCRETE PATH

SP
1

SP
1

NEW TREES

- 2 BBS Bucida buceras Black Olive "Shady Lady"
- 4 SP Sabal Palmetto Cabbage Palm

SHEET 11
EXISTING TREES
A BLACK OLIVE = 2

W. WAYNE HOOK
LICENSE NUMBER: LA0001593
1284 LASTRADA LANE
NAPLES, FLORIDA 34103-8943

REVISIONS			DRAWN BY	
DATE	BY	DESCRIPTION	KAS	MDP

AMERICAN ENGINEERING CONSULTANTS
OF MARCO ISLAND, INC.
CERTIFICATE OF AUTHORIZATION NUMBER: 26446
573 BALD EAGLE DRIVE MARCO ISLAND, FL 34145
(239) 394-1697 (FAX) 394-7571



CITY OF MARCO ISLAND
WINTERBERRY DRIVE FROM
PEACOCK TERRACE TO WEST SIDE
OF BARFIELD DRIVE

LANDSCAPING
IRRIGATION CONCEPT
PLAN SHEET

SHEET NO.
39

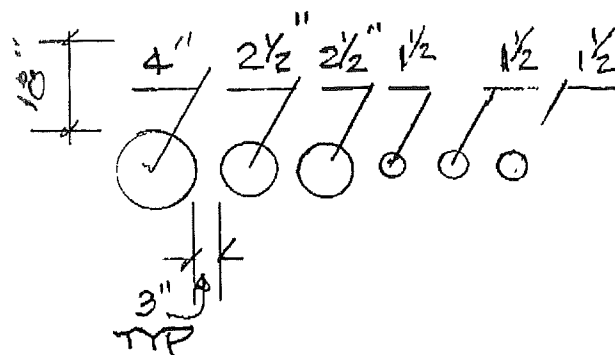

ALL SLEEVING MATERIAL
TO BE SCH. 40, EXTEND 14"
BEYOND THE PAVED PATH,
PIPE ENDS TO BE TAPED AND
SPACED 3" APART.

SLEEVING DETAIL

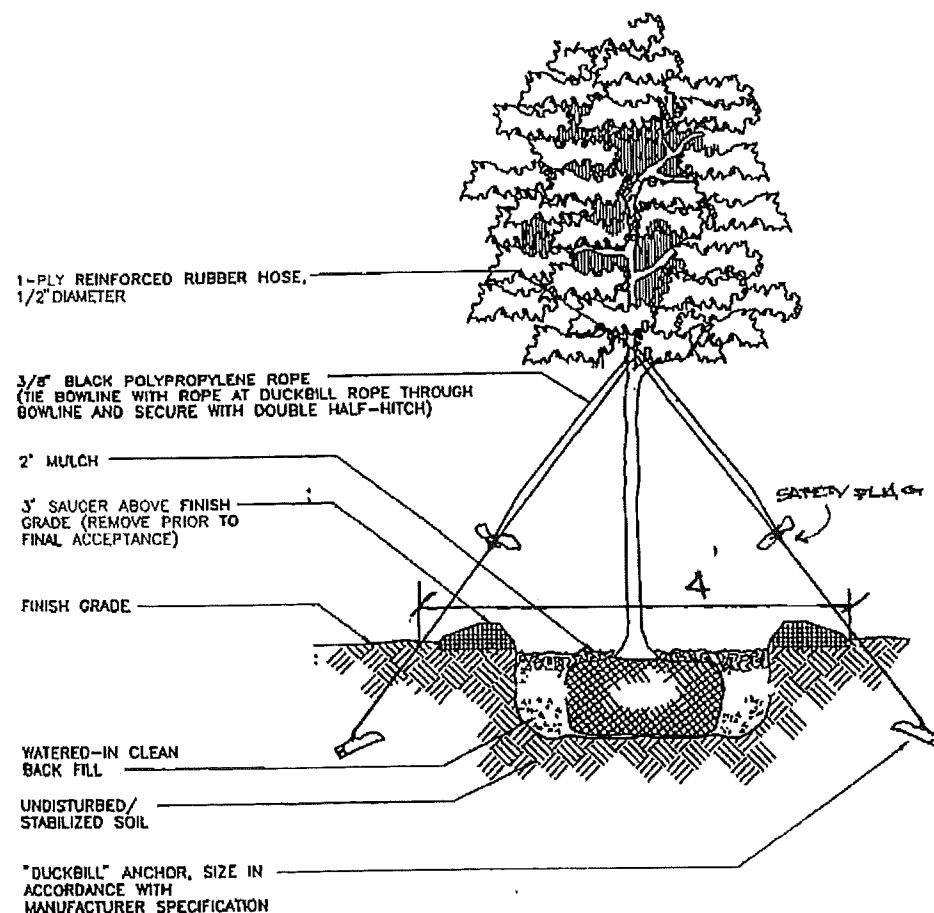

SINGLE TRUNK TREE 10'-20' O.A. HT.

WINTERBERRY NOTES:

- BURROWING OWLS ARE PROTECTED. IT IS ILLEGAL TO TAKE, HARM HARASS, OR IMPACT THIS ANIMAL, YOUNG, AND/OR BURROW.
- MOWER DECK AND WEED EATERS ARE TO BE NO CLOSER THAN 3 FEET TO TREES AND NO MOWING OVER MULCHED AREAS.
- MULCH AREAS ARE TO RECEIVE 3" LAYER OF PINE STRAW SPRING AND FALL.
- FERTILIZER TO BE APPLIED NO CLOSER THAN 12" TO THE TRUNK OF ANY NEW TREE. FORMATION AND QUANTITY SEE MANUFACTURERS DIRECTION, SPECIES OF PLANT AND SOIL CONDITIONS.
- IRRIGATION: HEADS SHOULD HAVE MATCHED PRECIPITATION RATES.
- ALL BIDDERS ARE TO WALK THE SITE FOR ANY QUESTIONS BEFORE BIDS. FIELD ADJUSTMENTS MAY BE NECESSARY AT INSTALLATION.

PLAN VIEW

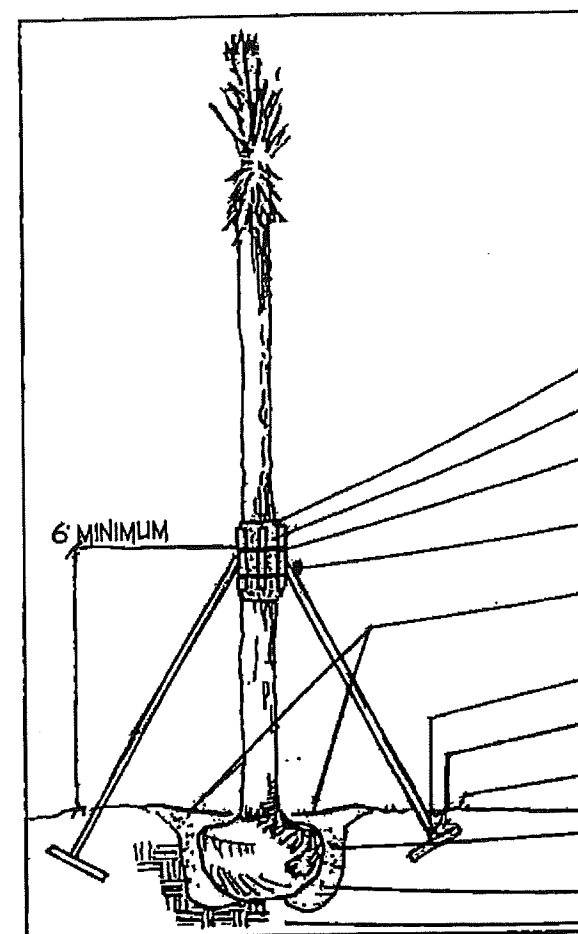
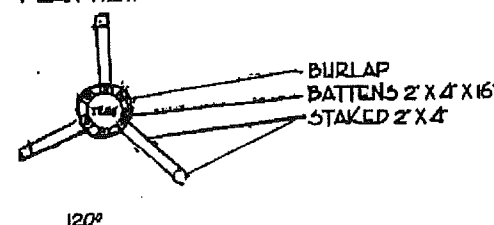

PLANTING AND STAKING DETAIL FOR SABAL PALMS

LANDSCAPE INSTALLATION NOTES

- THE CONTRACTOR SHALL VERIFY THE LOCATION OF ALL UTILITIES ON SITE BEFORE STARTING THE PROJECT, THE CONTRACTOR IS LIABLE FOR ALL DAMAGES TO AN UTILITY
- ALL PLANT MATERIAL SHALL BE FLORIDA #1 OR BETTER AS SPECIFIED BY THE DEPARTMENT OF AGRICULTURE'S 'GRADES & STANDARDS FOR NURSERY PLANTS'
- ALL SPECIFIED SIZES FOR PLANT MATERIAL SHALL BE CONSIDERED MINIMUM. PLANTS MUST MEET OR EXCEED THESE REQUIREMENTS.
- ALL PLANT MATERIAL INDICATED, AS SPECIMEN SHALL BE INSPECTED BY THE LANDSCAPE ARCHITECT PRIOR TO INSTALLATION.
- THE CONTRACTOR SHALL VERIFY LOCATION OF PLANT MATERIAL ON SITE WITH THE LANDSCAPE ARCHITECT BEFORE PLANTING. IF CONDITIONS ARISE THAT REQUIRES A SIGNIFICANT DESIGN CHANGE THE LANDSCAPE ARCHITECT PRIOR TO PLANTING SHALL APPROVE ALL TREES AND PALMS LOCATIONS.
- PLANTING BEDS OR AREAS CONTAINING LIME ROCK OR OTHERWISE UNSUITABLE GROWING MEDIUM SHALL HAVE THE MATERIAL REMOVED AND REPLACED WITH CLEAN NATIVE TOP SOIL OR SPECIFIED GROWING QUALITY SOIL THAT ALLOWS FOR GOOD PERCOLATION BEFORE THE PLANT INSTALLATION NOTIFY THE OWNERS REPRESENTATIVE OR LANDSCAPE ARCHITECT FOR APPROVAL OF THE ADDITIONAL SOIL.
- ALL EXISTING TREES OR VEGETATION TO BE PRESERVED SHALL BE PROTECTED AND BARRICADED OFF WITH ENVIRO FENCE. THE FENCE SHALL BE INSTALLED AT THE DRIP LINE OR AS MARKED BY THE LANDSCAPE ARCHITECT.
- PLANT QUANTITIES AS SPECIFIED IN THE PLANT SCHEDULE SHALL BE CONSIDERED ESTIMATES ONLY, SUBJECT TO FIELD COUNTS AND MEASUREMENTS.

CIGAR CUT
ON SABAL PALMS
OTHER PALMS TOPS TO BE TIED
DURING TRANSPORTATION AND PLANTING

MIN (3) 2' X 4' WOOD

3 LAYERS OF BURLAP

5 (2' X 4' X 16) BATTENS MINIMUM

STEEL BANDING (SHOULD NOT TOUCH
TRUNK OF THE PALM)

TOENAIL MINIMUM OF 3 (2' X 4) WOOD
BRACE TO THE BATTENS

WATER RING TO BE RAKED OUT
AT TIME OF MULCHING
MULCH FROM ALL PALM TRUNKS

2' X 4' PT STAKE

3" BELOW GRADE

FINISH GRADE

WATERED IN
CLEAN BACK FILL

REMOVE AIR POCKETS WHEN WATERING IN
EXISTING SOIL

* SET BACK 1"
HIGHER THAN FINISH
GRADE
3" MULCH AS SPECIFIED

WATERED-IN CLEAN
BACK FILL
UNDISTURBED SOIL

SHRUB PLANTING DETAIL

Wayne Hook
3/13/17

W. WAYNE HOOK
LICENSE NUMBER: LA0001593
1284 LASTRADA LANE
NAPLES, FLORIDA 34103-8943

REVISIONS			DRAWN BY	
DATE	BY	DESCRIPTION	KAS	MDP

AMERICAN ENGINEERING CONSULTANTS
OF MARCO ISLAND, INC.
CERTIFICATE OF AUTHORIZATION NUMBER: 26446
573 BALD EAGLE DRIVE MARCO ISLAND, FL 34145
(239) 394-1697 (FAX) 394-7571



CITY OF MARCO ISLAND
WINTERBERRY DRIVE FROM
PEACOCK TERRACE TO WEST SIDE
OF BARFIELD DRIVE

LANDSCAPE
DETAILS

SHEET
NO.
40

MARCO ISLAND WINTERBERRY GREENWAY
LIST OF EXISTING TREES

EXISTING TREES KEY

- A BLACK OLIVE
- B FOXTAIL PALM
- C SABAL PALM
- D CRAPE MYRTLE
- E OAK
- F PAUROTIS PALM
- G YELLOW ELDER
- H SILVER BUTTONWOOD
- I TABEBUIA
- J CASSIA
- K FLORIDA THATCH PALM
- L GUMBO LIMBO
- M JAMAICAN DOGWOOD
- N ROYAL POINCIANA
- O STRANGLER FIG
- P FUCYS BEBHANUBA
- Q EUCALYPTUS
- R COCONUT PALM
- S MANILKARA ROXBURGHIANA
- T HONK KONG ORCHID
- U YELLOW POINCIANA

SHEET 28

EXISTING TREES

- A BLACK OLIVE = 4
- B FOXTAIL PALM = 2
- C SABAL PALM = 3
- D CRAPE MYRTLE = 3
- E OAK = 4
- F PAUROTIS PALM = 1
- L GUMBO LIMBO = 1
- P FUCYS BEBHANUBA = 5
- Q EUCALYPTUS = 2
- R COCONUT PALM = 10
- S MANILKARA ROXBURGHIANA = 1
- U YELLOW POINCIANA = 3

SHEET 29

EXISTING TREES

- A BLACK OLIVE = 5
- B FOXTAIL = 4
- F PAUROTIS PALM = 8
- G ELLOW ELDER = 1
- H SILER BUTTONWOOD = 3
- P FUCYS BEBHANUBA = 2
- R COCONUT PALM = 3

EXISTING

BUTTERFLY GARDEN

SHEET 30

EXISTING TREES

- A BLACK OLIVE = 7
- B FOXTAIL PALM = 3
- C SABAL PALM = 2
- E OAK = 3
- F PAUROTIS PALM = 3
- L GUMBO LIMBO = 1
- T HONG KONG = 4

SHEET 31

EXISTING TREES

- A BLACK OLIVE = 2
- B FOXTAIL PALM = 2
- C SABAL PALM = 3
- T HONG KONG ORCHID = 3

SHEET 32

EXISTING TREES

- A BLACK OLIVE = 3
- B FOXTAIL = 3
- C SABAL PALM = 2
- D CRAPE MYRTLE = 11
- G YELLOW ELDER = 2
- S MANILKARA ROXBURGHIANA = 2

SHEET 33

EXISTING TREES

- A BLACK OLIVE = 6
- B FOXTAIL PALM = 2
- C SABAL PALM = 1

SHEET 34

EXISTING TREES

- A BLACK OLIVE = 2
- B FOXTAIL PALM = 3

SHEET 35

EXISTING SHRUBS

BROMELIADS +/- 40 UNDER THE ROYAL POINCIANA
(TO REMAIN)

EXISTING TREES

- A BLACK OLIVE = 1
- B FOXTAIL PALM = 4
- H SILVER BUTTONWOOD = 4
- I TABEBUIA = 6
- J CASSIA = 1
- K FLORIDA THATCH PALM = 5

SHEET 36

EXISTING TREES

- B FOXTAIL PALM = 7
- H SILVER BUTTONWOOD = 2
- J CASSIA = 1
- K FLORIDA THATCH PALM = 3
- L GUMBO LIMBO = 6
- M JAMAICAN DOGWOOD = 2
- N ROYAL POINCIANA = 1
- O STRANGLER FIG = 1

SHEET 37

EXISTING TREES

- A BLACK OLIVE = 3

SHEET 38

EXISTING TREES

- A BLACK OLIVE = 2

LIST OF EXISTING TREES

				WATER		
QTY	KEY	BOTANICAL NAME	COMMON NAME	SPECIFICATIONS	NATIVE	NEEDS
TREES						
12	BBS	Bucida buceras	Black Olive "Shady Lady"	45 gal 14' - 16' oa 3" cal 6' ct	N	M
2	CU	Coccoloba ubifera	Sea Grape	45 gal 12' - 14' oa 3" cal 5' ct	Y	L-M
6	QV	Quercus virginiana	Live Oak	45 gal 12' - 14' oa 3" cal 5' ct	Y	L-M
PALMS						
1	SP1	Sabal Palmetto	Cabbage Palm	10' - 16' gw fg, 8' ct	Y	L-M
2	SP	Sabal Palmetto	Cabbage Palm	65 gal 6' - 10' ct booted	Y	L-M
FLOWERING TREES						
4	BV	Bauhinia variegata	Hong Kong Orchid, White	25 gal 10' oa 2" cal 5' ct	N	M
2	DR	Delonix regia	Royal Poinciana, Orange	45 gal 12' - 14' oa 3" cal 5' ct	N	M
8	CS	Chorisia speciose	Floss Silk Tree, Pink	45 gal 12' - 14' oa 3" cal 5' ct	N	L-M
9	KE	Koelreuberia elegans	Golden Rain Tree	25 gal 10' oa 2" cal 5' ct	N	M
1	TI	Tabebuia impetiginosa	Tabebuia, Purple	25 gal 10' oa 2" cal 5' ct	N	M

HEDGE PLANT LIST

					WATER	
QTY	KEY	BOTANICAL NAME	COMMON NAME	SPECIFICATIONS	NATIVE	NEEDS
HEDGE						
184	CG	Clusia guttfera	Small Leaf Clusia	3 gal 18" - 24" oa	Y	M
95	CI	Chrysobalanus icaco	Coco Plum 'red tip'	3 gal 18" - 24" oa	Y	M
222	SA	Schefflera arboricola	Dwarf Arboricola	3 gal 18" - 24" oa	Y	M

ADDITIONAL MATERIAL

- MULCH - Pine Straw 3" thick in all beds
- MULCH - Pine Straw 5' diameter around All Trees (unless in large mulch bed)

SHEET 28 - HEDGE PLANTS

- 147 SA Dwarf Arboricola

SHEET 33 - NO HEDGE PLANTS

SHEET 29 - HEDGE PLANTS

- 35 SA Dwarf Arboricola

SHEET 34 - HEDGE PLANTS

- 72 CG Small Leaf Clusia

SHEET 30 - NO HEDGE PLANTS

SHEET 35 - HEDGE PLANTS

- 10 CG Small Leaf Clusia
- 40 CI Coco Plum 'red tip'

SHEET 31 - HEDGE PLANTS

- 40 SA Dwarf Arboricola

SHEET 36 - HEDGE PLANTS

- 55 CI Coco Plum 'red tip'

SHEET 32 - HEDGE PLANTS

- 102 CG Small Leaf Clusia

SHEET 28 - NO NEW TREES

SHEET 29 - NEW TREES

- 3 KE Koelreuberia elegans Golden Rain Tree

SHEET 30 - NEW TREES

- 1 CS Chorisia speciose Floss Silk Tree, Pink
- 2 QV Quercus virginiana Live Oak

SHEET 31 - NEW TREES

- 4 BBS Bucida buceras Black Olive "Shady Lady"
- 1 CS Chorisia speciose Floss Silk Tree, Pink
- 2 SP Sabal Palmetto Cabbage Palm
- 1 SP1 Sabal Palmetto Cabbage Palm
- 1 QV Quercus virginiana Live Oak
- 1 TI Tabebuia impetiginosa Tabebuia, Purple

SHEET 32 - NEW TREES

- 1 CS Chorisia speciose Floss Silk Tree, Pink
- 2 CU Coccoloba ubifera Sea Grape

SHEET 33 - NEW TREES

- 1 BBS Bucida buceras Black Olive "Shady Lady"
- 4 BV Bauhinia variegata Hong Kong Orchid, White
- 3 KE Koelreuberia elegans Golden Rain Tree
- 3 QV Quercus virginiana Live Oak

SHEET 34 - NEW TREES

- 5 BBS Bucida buceras Black Olive "Shady Lady"
- 3 CS Chorisia speciose Floss Silk Tree, Pink
- 2 DR Delonix regia Royal Poinciana, Orange
- 1 TI Tabebuia impetiginosa Tabebuia, Purple

SHEET 35 - NEW TREES

- CS Chorisia speciose Floss Silk Tree, Pink
- 3 KE Koelreuberia elegans Golden Rain Tree

SHEET 36 - NEW TREES

- 1 CS Chorisia speciose Floss Silk Tree, Pink

SHEET 37 - NO NEW TREES

SHEET 38 - NEW TREES

- 2 BBS Bucida buceras Black Olive "Shady Lady"

W. WAYNE HOOK
LICENSE NUMBER: LA0001593
1284 LASTRADA LANE
NAPLES, FLORIDA 34103-8943

REVISIONS				
DATE	BY	DESCRIPTION	DRAWN BY	KAS
			DESIGNED BY	MDP
			SCALE	1" = 20'
			DATE	2016
			JOB NO.	10067-089-04
			REFERENCE	PLAN

AMERICAN ENGINEERING CONSULTANTS
OF MARCO ISLAND, INC.
CERTIFICATE OF AUTHORIZATION NUMBER: 26446
573 BALD EAGLE DRIVE MARCO ISLAND, FL 34145
(239) 394-1697 (FAX) 394-7571



CITY OF MARCO ISLAND
WINTERBERRY DRIVE FROM
PEACOCK TERRACE TO WEST SIDE
OF BARFIELD DRIVE

LANDSCAPE
LEGEND

SHEET
NO.
41

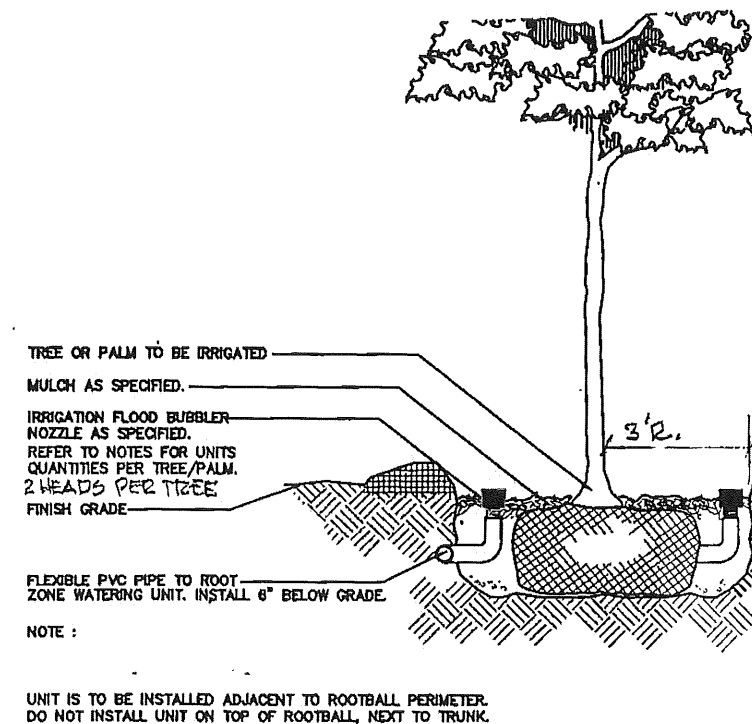
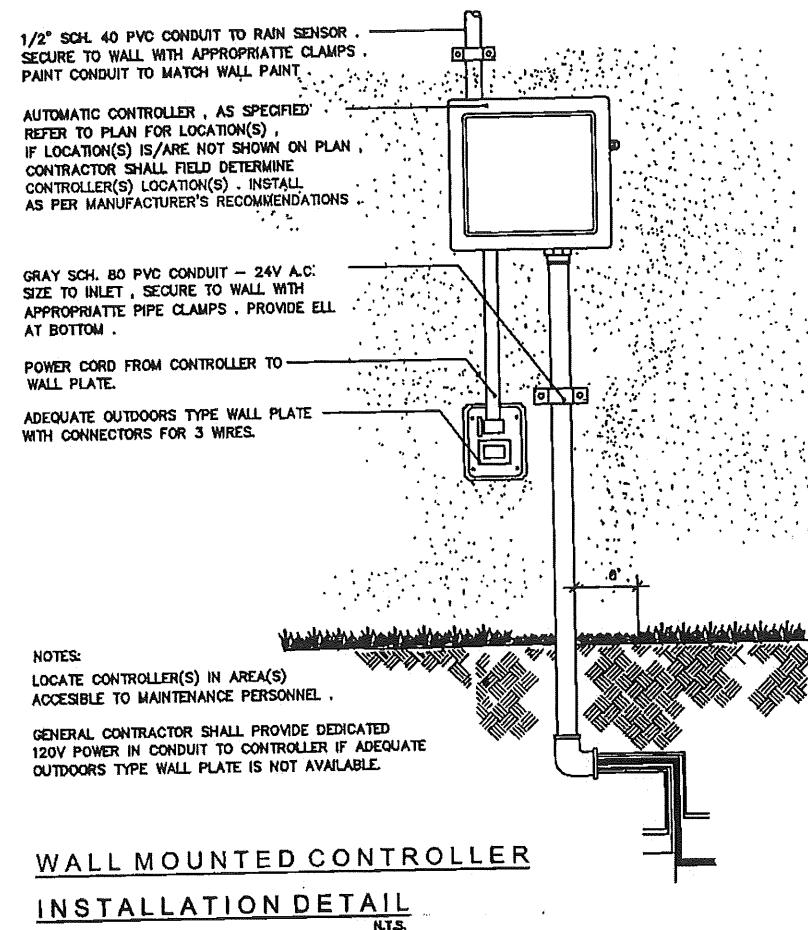

**TREE + PALM IRRIGATION WITH
RZWS UNIT INSTALLATION DETAIL**
N.T.S.

LANDSCAPE INSTALLATION NOTES

1. THE CONTRACTOR SHALL VERIFY THE LOCATION OF ALL UTILITIES ON SITE BEFORE STARTING THE PROJECT, THE CONTRACTOR IS LIABLE FOR ALL DAMAGES TO ANY UTILITY
2. ALL PLANT MATERIAL SHALL BE FLORIDA #1 OR BETTER AS SPECIFIED BY THE DEPARTMENT OF AGRICULTURE'S 'GRADES & STANDARDS FOR NURSERY PLANTS'
3. ALL SPECIFIED SIZES FOR PLANT MATERIAL SHALL BE CONSIDERED MINIMUM. PLANTS MUST MEET OR EXCEED THESE REQUIREMENTS.
4. ALL PLANT MATERIAL INDICATED, AS SPECIMEN SHALL BE INSPECTED BE THE LANDSCAPE ARCHITECT PRIOR TO INSTALLATION.
5. THE CONTRACTOR SHALL VERIFY LOCATION OF PLANT MATERIAL ON SITE WITH THE LANDSCAPE ARCHITECT BEFORE PLANTING. IF CONDITIONS ARISE THAT REQUIRES A SIGNIFICANT DESIGN CHANGE THE LANDSCAPE ARCHITECT PRIOR TO PLANTING SHALL APPROVE ALL TREES AND PALMS LOCATIONS.
6. PLANTING BEDS OR AREAS CONTAINING LIME ROCK OR OTHERWISE UNSUITABLE GROWING MEDIUM SHALL HAVE THE MATERIAL REMOVED AND REPLACED WITH CLEAN NATIVE TOP SOIL OR SPECIFIED GROWING QUALITY SOIL THAT ALLOWS FOR GOOD PERCOLATION BEFORE THE PLANT INSTALLATION NOTIFY THE OWNERS REPRESENTATIVE OR LANDSCAPE ARCHITECT FOR APPROVAL OF THE ADDITIONAL SOIL.
7. ALL EXISTING TREES OR VEGETATION TO BE PRESERVED SHALL BE PROTECTED AND BARRICADED OFF WITH ENVIRO FENCE. THE FENCE SHALL BE INSTALLED AT THE DRIP LINE OR AS MARKED BY THE LANDSCAPE ARCHITECT.
8. PLANT QUANTITIES AS SPECIFIED IN THE PLANT SCHEDULE SHALL BE CONSIDERED ESTIMATES ONLY, SUBJECT TO FIELD COUNTS AD MEASUREMENTS.
9. SOD AREAS NOTED ON THE PLAN TO RECEIVE TURF SHALL BE SODDED WITH ST. AUGUSTINE FLORATAM PALMETTO SAND GROWN, LAID TIGHT WITH OVERLAPPING SEAMS, SOIL TO BE RAKED SMOOTH FREE OF DEBRIS AND STONES AND MOIST PRIOR TO LAYING SOD. SOD IS TO BE ROLLED IMMEDIATELY AFTER LAYING AND FERTILIZED WITHIN TWO WEEK OF INSTALLATION SOD IS TO BE FREE OF INSECTS AND FUNGUS UNTIL ACCEPTANCE.
10. EXISTING EXOTIC VEGETATION AS LISTED IN THE LOCAL ZONING OR DEVELOPMENT ORDINANCES SHALL BE REMOVED OR TREATED WITH A HERBICIDE AS LISTED IN EXOTIC VEGETATION REMOVAL PLAN OR AS DIRECTED
11. POSSIBLE FUTURE PLANTING FOR OPEN NON-PLANTED AND NON-MULCHED AREAS, COULD INCLUDE JASMINE ASIATICUM OR PERIANAL PEANUT. IRRIGATION FOR THESE AREAS WOULD HAVE TO BE ADDED TO THE IRRIGATION PLAN.

W. WAYNE HOOK
LICENSE NUMBER: LA0001593
1284 LASTRADA LANE
NAPLES, FLORIDA 34103-8943

REVISIONS			DRAWN BY	KAS
DATE	BY	DESCRIPTION	DESIGNED BY	MDP
			SCALE	N.T.S.
			DATE	2016
			JOB NO.	10087-089-04
			REFERENCE	PLAN

**AMERICAN ENGINEERING CONSULTANTS
OF MARCO ISLAND, INC.**
CERTIFICATE OF AUTHORIZATION NUMBER: 26446
573 BALD EAGLE DRIVE MARCO ISLAND, FL 34145
(239) 394-1697 (FAX) 394-7571



CITY OF MARCO ISLAND
WINTERBERRY DRIVE FROM
PEACOCK TERRACE TO WEST SIDE
OF BARFIELD DRIVE

**IRRIGATION
DETAILS**

SHEET
NO.
42

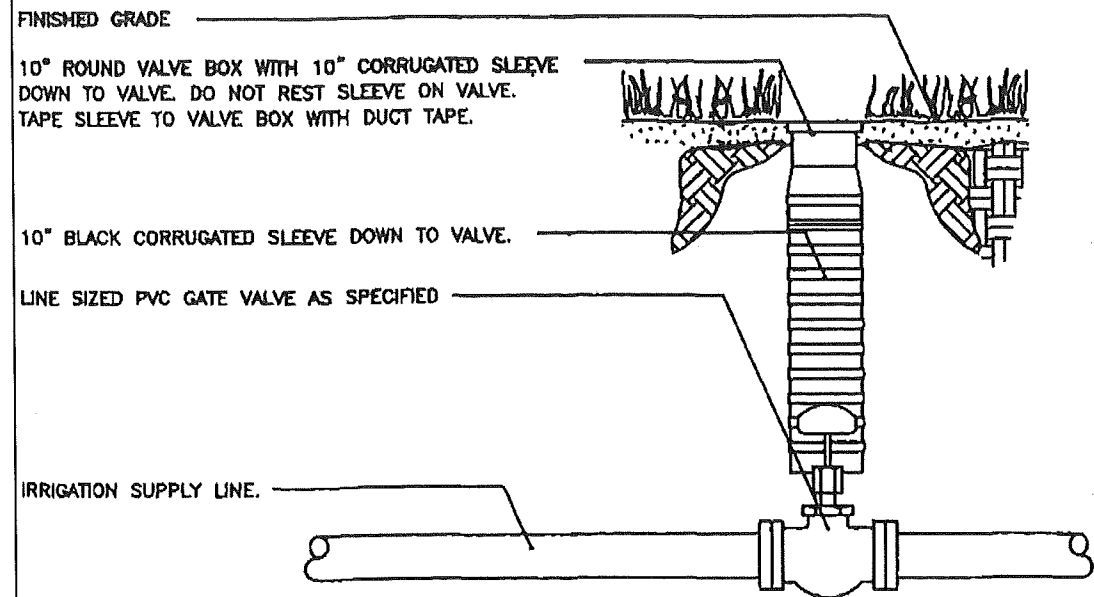

MAIN LINE ISOLATION MANUAL GATE VALVE INSTALLATION DETAIL
N.T.S.

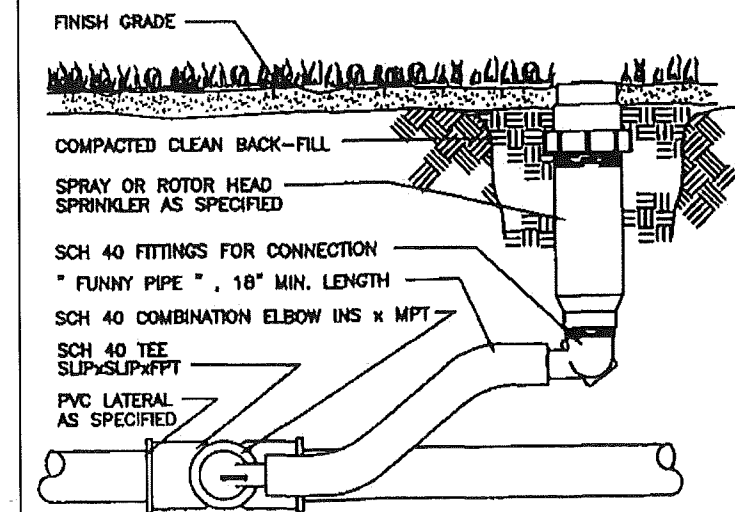

NOTE:
NO SPRINKLER HEADS SHALL OCCUR WITHIN 9" OF SIDEWALKS, PAVED AREAS, BEDLINES, AND 15" FROM BUILDINGS.

POP-UP SPRINKLER INSTALLATION DETAIL
N.T.S.

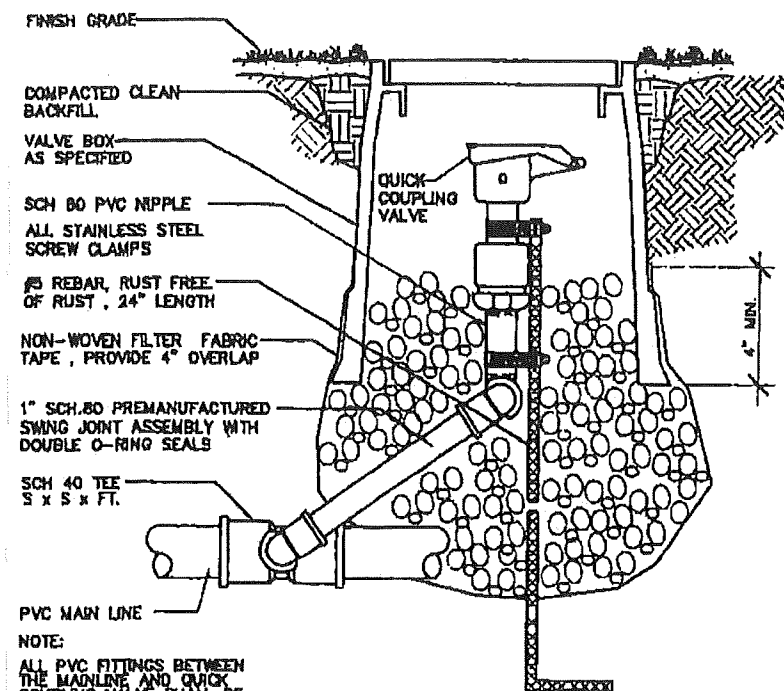

NOTE:
ALL PVC FITTINGS BETWEEN THE MAINLINE AND QUICK COUPLING VALVE SHALL BE EQUIVALENT TO THE QUICK COUPLING VALVE SIZE.

QUICK COUPLING VALVE INSTALLATION DETAIL
N.T.S.

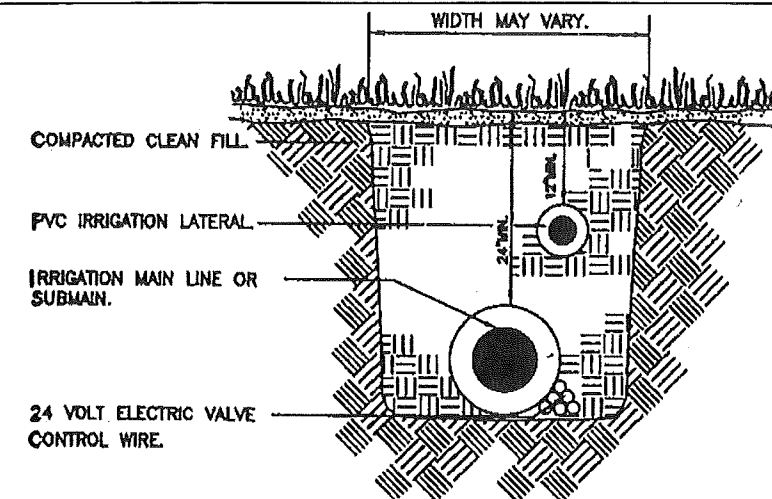

ALL TRENCHING DEPTHS SHOWN ARE MINIMUM. IN THE EVENT THAT MINIMUM TRENCHING DEPTHS ARE NOT MET, THE TRENCHES SHALL BE RE-EXCAVATED.

DEPTH MEASUREMENTS ARE TO BE DONE FROM FLUSH GRADE TO TOP OF PIPE.

PROVIDE A 6" MINIMUM VERTICAL SEPARATION BETWEEN MAIN LINE(S) AND LATERAL LINE(S).

ALL TRENCHES SHALL BE BACKFILLED WITH CLEAN SOIL FREE OF DEBRIS & NOXIOUS WEEDS. TRENCHES SHALL BE COMPACTED TO A 90% STANDARD PROCTOR DENSITY, ASTM D 698-78.

PIPE PULLING THROUGH UN-TRENCHED SOIL IS NOT ALLOWED UNDER ANY CIRCUMSTANCE.

TYPICAL TRENCHING DETAIL
N.T.S.

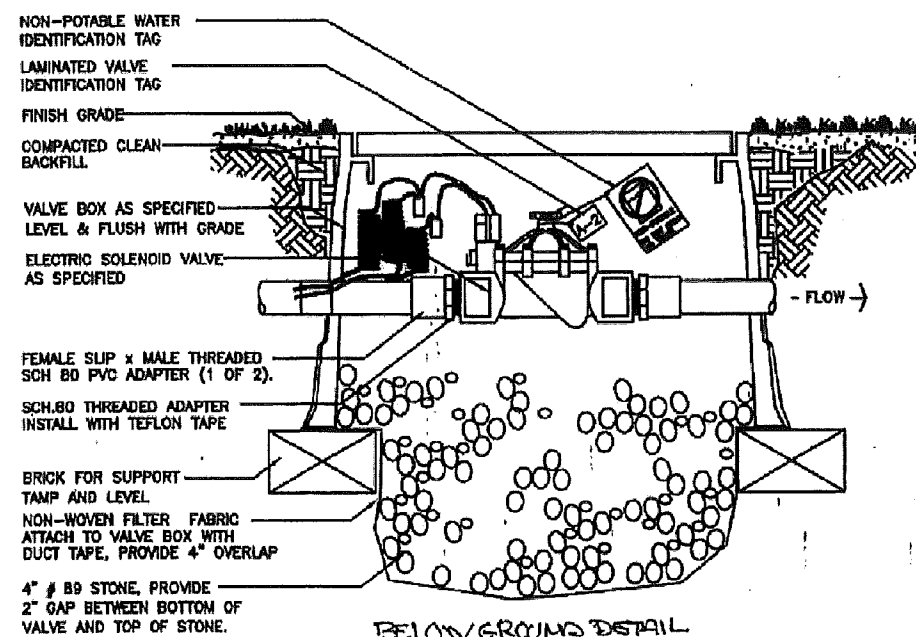

THE MAIN LINE AND LATERAL LINES ARE TO BE INSTALLED ABOVE GRADE, BUT THE ELECTRIC SOLENOID VALVES SHALL BE INSTALLED BELOW GRADE FOR BETTER ANCHORING/SECURING, AS WELL AS PROTECTION FROM DIRECT SUNLIGHT DETERIORATION AND SALT SPRAY PROTECTION.

ELECTRIC SOLENOID VALVE INSTALLATION DETAIL
N.T.S.

REVISIONS			DRAWN BY	
DATE	BY	DESCRIPTION	KAS	MDP
			SCALE	N.T.S.
			DATE	2016
			JOB NO.	10067-089-04
			REFERENCE	PLAN

AMERICAN ENGINEERING CONSULTANTS OF MARCO ISLAND, INC.
CERTIFICATE OF AUTHORIZATION NUMBER: 26446
573 BALD EAGLE DRIVE MARCO ISLAND, FL 34145
(239) 394-1697 (FAX) 394-7571



CITY OF MARCO ISLAND
WINTERBERRY DRIVE FROM
PEACOCK TERRACE TO WEST SIDE
OF BARFIELD DRIVE

W. Wayne Hook
3/13/17

W. WAYNE HOOK
LICENSE NUMBER: LA0001593
1284 LASTRADA LANE
NAPLES, FLORIDA 34103-8943

**IRRIGATION
DETAILS**

SHEET
NO.
43

Marco Island Winterberry Greenway
IRRIGATION NOTES

IRRIGATION NOTES:

The plant pallet lists the water demands of the plant materials for this site, there are no high water demands plans used.

This site plan is broken into the following areas for the types of irrigation needs:

1. Stream Bubblers for the existing trees
2. New Drip Flood Irrigation for New and Existing
3. Mist Heads for shrubs and hedges

This plan is a preconstruction concept, the Irrigation Contractor may have to make field adjustments to the actual conditions, provided by the City of Marco. The actual numbers of heads per zone and the number of zones to be determined by the PSI and GPM at the time of installation. The mist zones are to provide 100% head-to-head coverage.

IRRIGATION INFORMATION:









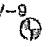

- A. Irrigation contractor to be licensed in Collier County and City of Marco Island and is to furnish all permits required by the County/City for the installation of this system.
- B. Furnish the general contractor a loose-leaf Service Manual for all equipment installed
- C. Furnish two sets of As-Built Plans showing Irrigation main line routing, connections to water source, control and gate valves. The As-Built Plan shall be dimensioned from the underline routing, connecting point, control valves and gate valves, and quick couplers.
- D. Sleeve locations are shown on the Irrigation Sheets 29-37.
- E. Trees, hedges, and large shrubs locations should be marked prior to trenching mainlines
- F. Verify the grade is at finished grade prior to installation
- G. The application rate must not exceed the ability of the soil to absorb and retain the water applied during application
- H. Distribution equipment (such as sprinkler, bubblers devices) in any given zone must have the same precipitation rate.
- I. No turf has been included as part of this plan
- J. Water conveyance system should be designed with flow velocity not to exceed 5 feet per second
- K. Pipelines should be designed to provide the system with the appropriate pressure required for maximum irrigation uniformity.
- L. Pressure regulating or compensating equipment must be used where the system pressure exceeds the manufacturer's recommendations.
- M. Nonplanted areas, including impervious surfaces should not be irrigated.
- N. Irrigation sources to be determined by the City of Marco Island
- O. The type of water (potable or non-potable) to be determined by the Contractor, Engineer or City of Marco Island. If non-potable water is chosen all purple pipe and other materials must the City and County Codes relating to the use of non-potable water for irrigation.
- P. Irrigation controller location to be determined by the City of Marco Island.
- Q. The Conceptual Plan presented is based on the numbers provided by the Engineering Firm, one back flow preventer to be supplied by the City of Marco with a net preserve of 70 PSI and supply of 80 GPM. Pressure regulation to be supplied by Contractor as needed.
- R. Isolation valves should be provided before and after the back flow preventer.

Field check the existing tree quantities as some existing trees were in poor condition at the time of the design preparation. Bid schedule determined by others.

TYPICAL IRRIGATION DEVELOPMENT NOTES

1. All specified mist driplines and bubbler irrigation systems shall be installed per manufactures recommendations and specifications.
2. Xeri-tuping black stripe tubing shall be trenched into a depth of 12" when running between tree locations
3. Individual tree bubblers and the last bubbler at the end of a line shall have easy fit flush caps.
4. In park location where existing irrigation is present the contractor shall coordinate system layout with existing system layout, where possible.

SYMBOL DESCRIPTION

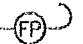
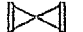
	Irrigation system source: 1.5" water meter and backflow preventer where required. Field adjust final location based on water service availability.
	1" Quick coupler valve installed within jumbo size valve box.
	Medium Flow Kit (1" DV Valve + 1" BFF + 40psi Pressure Regulator + Check valve), include a 1" pvc ball isolation Valve within a Jumbo size valve box.
	Valve V-9 - brass 1.25" valve assembly per detail with two wire decoder for Hunter Genesis Viking Controller. Connect valve into existing 3" main and two wire system
NO SYMBOL	battery operated controller with rain shut-off device One per valve install within control valve box.
	4" Sch. 40 pvc Irrigation sleeves (Trenched in at 36" depth)
	2" Sch. 40 pvc Irrigation sleeves (Trenched in at 36" depth)
	4" HDPE-Class 150 SDR11 Extra molecular weight HDPE Irrigation sleeves per FDOT standards Directional Bore at 40" min. depth.
	2" PVC 1120-1220 Class 200 Irrigation main line solvent welded
	Class 200 PVC Lateral Pipe
	Landscape Dripline with 24 inch spaced emitters
INSTALL FLOW AND PRESSURE REGULATORS WHERE REQUIRED	
	Pressure Regulators PSI-M40-100
	Irrigation Main line blow off points, 3" & 1-1/2" SCH 80 Piping & Fittings, 1-1/2" series manual gate valve, valve boxes & other elements as per detail.
	2" main line isolation gate valve. Flanged connection, non-rising stem, square nut.

IRRIGATION LEGEND

Field check the existing tree quantities as some existing trees were in poor condition at the time of the design preparation. Bid schedule determined by others.

PIPING AND OTHER ELEMENTS ARE SHOWN ON PAVED SURFACES AND/OR ADJACENT PROPERTY FOR GRAPHIC CLARITY ONLY. ACTUAL LOCATION SHALL BE WITHIN THE PROJECT'S DESIGNATED LANDSCAPE AREAS. FIELD ADJUST AS NEEDED.

REVISIONS			DRAWN BY	KAS
DATE	BY	DESCRIPTION	DESIGNED BY	NDP
			SCALE	N.T.S.
			DATE	2016
			JOB NO.	10067-089-04
			REFERENCE	PLAN

AMERICAN ENGINEERING CONSULTANTS
OF MARCO ISLAND, INC.
CERTIFICATE OF AUTHORIZATION NUMBER: 26446
573 BALD EAGLE DRIVE MARCO ISLAND, FL 34145
(239) 394-1697 (FAX) 394-7571



CITY OF MARCO ISLAND
WINTERBERRY DRIVE FROM
PEACOCK TERRACE TO WEST SIDE
OF BARFIELD DRIVE

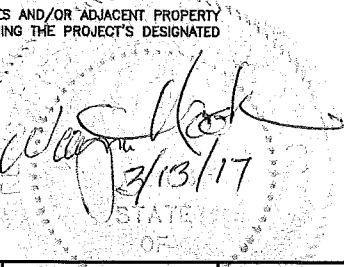

W. WAYNE HOOK
LICENSE NUMBER: LA0001593
1284 LASTRADA LANE
NAPLES, FLORIDA 34103-8943

IRRIGATION LEGEND

SHEET
NO.

44